

ARCHITECTS CERTIFICATION

I, Albert M. Demerich, RLA, ASLA, HEREBY CERTIFY THAT I AM A REGISTERED LANDSCAPE ARCHITECT IN THE STATE OF DELAWARE. THAT THE LANDSCAPE INFORMATION SHOWN HEREON HAS BEEN PREPARED UNDER MY SUPERVISION AND TO MY BEST KNOWLEDGE AND BELIEF, REPRESENTS GOOD LANDSCAPE PRACTICES.

Albert M. Demerich, RLA, ASLA LICENSE # S1-0000394 DATE FEBRUARY 12, 2024

ITEM	REQUIRED/ALLOWED	PROVIDED
STREET TREES	1 TREE PER 30 LINEAR FEET	ROUTE 13 781 FT ROAD FRONTAGE - 50 FT ENTRANCE = 23 LINEAR FEET 731 / 30 = 25 TREES REQUIRED
		ROUTE 404 359 FT ROAD FRONTAGE - 80 FT ENTRANCE = 279 LINEAR FEET 279 / 30 = 10 TREES REQUIRED
PARKING LANDSCAPE ISLANDS	1 LANDSCAPE ISLAND PER 25 PARKING SPACES	108 PROVIDED 1,523 SPACES / 25 = 61 ISLANDS REQUIRED

ERNST SEEDS
Ernst Conservation Seeds
8884 Mercer Pike
Meadville, PA 16335
(800) 873-3321 Fax (814) 336-5191
www.ernstseed.com

SUBMERGED GRAVEL WETLANDS

Date: January 15, 2024

Seasonally Flooded Wildlife Food Mix - ERNMX-128

Botanical Name	Common Name
21.50 % Panicum clandestinum, Tioga	Deertongue, Tioga
20.00 % Elymus virginicus, Madison-NY Ecotype	Virginia Wildrye, Madison-NY Ecotype
16.00 % Andropogon gerardii, Niagara	Big Bluestem, Niagara
15.00 % Echinochloa crusgalli var. frumentacea	Japanese Millet
10.00 % Carex vulpinoidea, PA Ecotype	Fox Sedge, PA Ecotype
8.00 % Panicum virgatum, Shawnee	Switchgrass, Shawnee
4.00 % Chamaecrista fasciculata, PA Ecotype	Partridge Pea, PA Ecotype
1.50 % Verbena hastata, PA Ecotype	Blue Vervain, PA Ecotype
1.00 % Helopsis helathoides, PA Ecotype	Chevy Sunflower, PA Ecotype
1.00 % Junco effusus	Soft Rush
0.80 % Agrostis perennans, Albany Pine Bush-NY Ecotype	Autumn Bentgrass, Albany Pine Bush-NY Ecotype
0.10 % Aeluropus incarnata, PA Ecotype	Swamp Milkweed, PA Ecotype
0.10 % Aster novae-angliae, PA Ecotype	New England Aster, PA Ecotype
0.10 % Eupatorium fulvifolium, PA Ecotype	Joe-Pye Weed, PA Ecotype
0.10 % Mimulus ringens, PA Ecotype	Square Stemmed Monkeyflower, PA Ecotype
0.10 % Monarda fistulosa, Fort Indiantown Gap-PA Ecotype	Wild Bergamot, Fort Indiantown Gap-PA Ecotype
0.10 % Pycnanthemum tenuifolium	Narrowleaf Mountainmint

100.00 %
Seeding Rate: 20 lb per acre, or 1/2 lb per 1,000 sq ft with a cover crop. For a cover crop use one of the following: grain rye (1 Sep to 30 Apr; 30 lbs/acre), Japanese millet (1 May to 31 Aug; 10 lbs/acre), or barnyard grass (1 May to 31 Aug; 10 lbs/acre).

Grasses & Grass-like Species - Herbaceous Perennial; Herbaceous Flowering Species - Herbaceous Perennial; Wet Meadows & Wetlands; Wildlife Habitat & Food Plots

This combination of annual and perennial grasses, forbs and grass-like plants provide food and cover in wet or flooded riparian areas, as well as in draw-down areas in retention basins or wetlands. Seed from October-May. Mix formulations are subject to change without notice depending on the availability of existing and new products. While the formula may change, the guiding philosophy and function of the mix will not.

ERNST SEEDS
Ernst Conservation Seeds
8884 Mercer Pike
Meadville, PA 16335
(800) 873-3321 Fax (814) 336-5191
www.ernstseed.com

PLAN KEY BASIN'S 5, 10 & 13

Date: January 01, 2024

Retention Basin Floor Mix - Low Maintenance - ERNMX-126 (or approved equal)

Botanical Name	Common Name
20.00 % Panicum clandestinum, Tioga	Deertongue, Tioga
20.00 % Puccinellia distans, Falls	Alkaligrass, Falls
18.00 % Elymus virginicus, Madison-NY Ecotype	Virginia Wildrye, Madison-NY Ecotype
15.00 % Agrostis stolonifera, Pennecross	Creeping Bentgrass, Pennecross
15.00 % Poa palustris	Fowl Bluegrass
10.00 % Carex vulpinoidea, PA Ecotype	Fox Sedge, PA Ecotype
1.00 % Carex scoparia, PA Ecotype	Blunt Broom Sedge, PA Ecotype
1.00 % Junco effusus	Soft Rush

100.00 %
Seeding Rate: 20-40 lbs per acre, or 0.5-1 lb/1,000 sq ft with a cover crop. For a cover crop use one of the following: grain rye (1 Sep to 30 Apr; 30 lbs/acre), Japanese millet (1 May to 31 Aug; 10 lbs/acre), or barnyard grass (1 May to 31 Aug; 10 lbs/acre).

Grasses & Grass-like Species - Herbaceous Perennial; Stormwater Management
The hardy, inexpensive grass and grass-like species are ideal for retention basins that may have high salt inflows and where mowing may be required.
Mix formulations are subject to change without notice depending on the availability of existing and new products. While the formula may change, the guiding philosophy and function of the mix will not.

MASTER PLANT LIST

KEY	QUAN	BOTANICAL NAME	COMMON NAME	SIZE	ROOT	COMMENTS
CANOPY TREES						
ARRS	54	ACER RUBRUM 'RED SUNSET'	RED SUNSET RED MAPLE	2 - 2.5' CAL	B&B	
GB	16	GINKGO BILBOA 'SHANGRI-LA'	SHANGRI-LA GINKGO	2 - 2.5' CAL	B&B	
GT	53	QUERCUS LAEVOLENS VAR. NERMISS 'SHADEMASTER'	SHADEMASTER HONEYLOCUST	2 - 2.5' CAL	B&B	
QA	57	QUERCUS ALBA	WHITE OAK	2 - 2.5' CAL	B&B	
OP	25	QUERCUS PALUSTRIS	PIN OAK	1.5 - 2' CAL	B&B	
QPH	19	QUERCUS PHELLOS 'HIGHTOWER'	HIGHTOWER HOLLOW OAK	1.5 - 2' CAL	B&B	
ZS	78	ZELKOVA SERRATA 'VILLAGE GREEN'	VILLAGE GREEN ZELKOVA	2 - 2.5' CAL	B&B	
UNDERSTORY TREES						
CC	18	CERCIS CANADENSIS	EASTERN REDBUD	6 - 7' HT	B&B	TREE FORM
LN	22	LAGERSTROEMIA 'NATCHEZ'	NATCHEZ CRAPPEMYRTLE	6 - 7' HT	B&B	TREE FORM
MST	44	MALLUS SUGAR TUNE	SUGAR TUNE CRABAPPLE	7 - 8' HT	B&B	TREE FORM
PSY	29	PRUNUS X YEDOENSIS	JAPANESE FLOWERING CHERRY	6 - 7' HT	B&B	TREE FORM/CLEAN GRAFT ON STANDARD
SR	19	SYRINGA RETICULATA 'SNOW DANCE'	SNOW DANCE TREE LILAC	7 - 8' HT	B&B	
EVERGREEN TREES						
CJ	34	CRYPTOMERIA JAPONICA 'YOSHINO'	YOSHINO JAPANESE CRYPTOMERIA	6 - 7' HT	B&B	HEAVY, FULL TO GROUND
MJ	44	MAGNOLIA GRANDIFLORA 'BRACKENS BROWN BEAUTY'	BRACKEN'S BROWN BEAUTY MAGNOLIA	6 - 7' HT	B&B	FULL TO GROUND
PS	71	PRINUS STROBUS	EASTERN WHITE PINE	6 - 7' HT	B&B	FULL TO GROUND
TP	59	THUJA PLICATA 'GREEN GIANT'	GREEN GIANT WESTERN ARBORVITAE	5 - 6' HT	B&B	
SHRUBS						
IC	97	ABELIA X GRANDIFLORA 'LITTLE RICHARD'	LITTLE RICHARD ABELIA	18 - 24" HT	3 gal. cont.	5' O.C.
IGS	191	ILEX CRENATA 'SOFT TOUCH'	SOFT TOUCH JAPANESE HOLLY	18 - 24" HT	3 gal. cont.	3' O.C.
IC	364	ILEX GLABRA 'SHAMROCK'	SHAMROCK INKBERRY HOLLY	18 - 24" HT	3 gal. cont.	3' O.C.
SGM	300	SPIRAEA 'GOLD MOUND'	GOLD MOUND SPIRAEA	18 - 24" HT	3 gal. cont.	3' O.C.
SJP	296	SPIRAEA JAPONICA 'SHIROBANA'	SHIROBANA JAPANESE SPIRAEA	18 - 24" HT	3 gal. cont.	3' O.C.
VP	18	VIBURNUM PRUNIFOLIUM	BLACKHAW VIBURNUM	24 - 30" HT	7 gal. cont.	5' O.C.
VPT	13	VIBURNUM PLICATUM 'TOMENTOSUM 'SHASTA'	SHASTA DOUBLEFILE VIBURNUM	24 - 30" HT	7 gal. cont.	5' O.C.
PERENNIALS						
X-LM	1190	LIRIOPE MUSCARI 'BIG BLUE'	BIG BLUE LIRIOPE	F.P.E.	1 qt. cont.	1.5' O.C.
X-LM	1568	LIRIOPE MUSCARI 'VARIEGATA'	VARIEGATED LIRIOPE	F.P.E.	1 qt. cont.	1.5' O.C.
X-PO	598	PENNESETUM ALOPECUROIDES 'HAEMEL'	HAEMEL FOUNTAIN GRASS	F.P.E.	1 qt. cont.	1.5' O.C.

NOTE: F.P.E. = FULL TO POT EDGE.

LANDSCAPE NOTES

- MULCH ALL TREE PITS, PLANT BEDS, AND GROUND COVER AREAS WITH A MINIMUM 3" DEPTH (AFTER SETTLEMENT) OF MULCH OR AS NOTED.
- THIS DRAWING TO BE USED FOR LANDSCAPE DEVELOPMENT PURPOSES ONLY.
- ALL TREE STAKING, GUYING, AND WRAPPING SHALL BE REMOVED AFTER ONE YEAR.
- ALL SHRUB, FLOWER, AND GROUND COVER BEDS SHALL BE PITCHED OR CROWNED TO ASSURE A MINIMUM SURFACE PITCH OF 3% FOR POSITIVE SURFACE DRAINAGE.
- ALL PROPOSED LANDSCAPE PLANT MATERIAL TO BE GUARANTEED FOR A PERIOD OF TWELVE MONTHS FROM THE DATE OF ACCEPTANCE, AGAINST DEFECTS INCLUDING DEATH AND UNSATISFACTORY GROWTH. EXCEPT FOR DEFECTS RESULTING FROM NEGLIGENCE BY OWNER, ABUSE OR DAMAGE BY OTHERS, OR UNUSUAL PHENOMENA OR INCIDENTS WHICH ARE BEYOND LANDSCAPE INSTALLER CONTROL. CONTRACTOR, IF NOT MAINTAINING THE PROPERTY DURING THE GUARANTEE PERIOD, SHALL BE RESPONSIBLE FOR MAKING MONTHLY INSPECTIONS AND ISSUING WRITTEN REPORTS DETAILING ANY MAINTENANCE PRACTICES HE OBSERVES WHICH WOULD IN ANYWAY NEGATE HIS GUARANTEE OBLIGATION.
- ALL AREAS BEYOND THE LIMIT OF LAWN/GROUND COVER THAT ARE DISTURBED BY CONSTRUCTION OPERATIONS SHALL BE REPAIRED TO PRE-CONSTRUCTION CONDITION AND/OR TO COMPLY WITH STANDARDS INDICATED ON THE SOIL EROSION AND SEDIMENT CONTROL PLAN.
- ALL TREES ADJACENT TO CURBS (OR EDGE OF PAVEMENT) SHALL BE PLACED 6'-0" AWAY FROM THE CURB FACE MEASURED TO THE CENTERLINE OF THE TREE TRUNK. IF PLACED IN THE MEDIAN ISLAND, THEY SHALL BE CENTERED IN THE SPACE BETWEEN THE CURBS OR AS NOTED ON THE LANDSCAPE PLAN. ALL TREES PLANTED ADJACENT TO PEDESTRIAN WALKWAYS SHALL BE BRANCHED AT 6" INDIALLY.
- NO PLANT MATERIAL ABOVE 24" WILL BE INSTALLED WITHIN ANY APPROVED SIGHT TRIANGLE.
- PLANT BACKFILL MIX SHALL CONTAIN THE FOLLOWING:
1 PART AMENDED TOPSOIL (SCREENED) WITH FERTILIZATION AS REQUIRED BELOW:

AMENDED TOPSOIL SHALL BE WITHOUT ADMIXTURE OF SUBSOIL OR SLAG AND SHALL BE FREE OF STONES, LUMPS, PLANTS OR THEIR ROOTS, STICKS AND EXTRANEOUS MATTER, AND SHALL NOT BE MOVED, PLACED OR USED WHILE IN FROZEN OR MUDDY CONDITION. TOPSOIL SHALL HAVE AN ACIDITY RANGE OF pH 5.0 TO 7.0 AND SHALL CONTAIN NOT LESS THAN 5% ORGANIC MATTER AS DETERMINED BY THE 'WALKLEY-BLACK METHOD' (COLORIMETRIC VERSION). SUFFICIENT LIMESTONE SHALL BE ADDED TO TOPSOIL USED TO BRING SOIL TO RANGE OF pH 6.0 TO pH 6.5. THERE SHALL BE A MINIMUM OF 12" OF TOPSOIL (AFTER SETTLEMENT) IN ALL PLANT BEDS, OR GROUND COVER AREAS AND 3" IN ALL FINE LAWN, SEEDING AREAS OR AS CALLED FOR.

- FERTILIZATION: 1. FOR TREES, SHRUBS AND ALL GROUND COVER (HERBACEOUS AND CONIFEROUS) "TERRA-SORB" AG AT THE RATE OF 32 OZ PER CUBIC YARD OF SOIL MIX.
2. FOR TREES AND SHRUBS EXCLUDING CONIFEROUS GROUND COVER: PHC HEALTHY START 34-3-3 ORGANIC FERTILIZER/SOIL CONDITIONER, SHALL BE APPLIED AT 1/2 LB. PER TRUNK DIAMETER (CAL. INCH) FOR TREES.
FOR SHRUBS USE THE FOLLOWING TABLE:

PLANT SIZE	RATE CUPS	LBS.	#PLANT BAG
1 GALLON	1/2	1/4	100
5 GALLON	1	1/2	50
15 GALLON	2	1	25
24" BALLBOX	3	1 1/2	16
36" BALLBOX	5	2 1/2	10
42" BALLBOX	6	3	8
54" BALLBOX	8	4	6
72" BALLBOX	10	5	5

FOR HERBACEOUS AND CONIFEROUS GROUND COVER: DRY ROOTS 2 SHALL BE APPLIED AT THE FOLLOWING RATES:

PLANT SIZE	RATE CUPS	LBS.	#PLANT BAG
15-18" B&B	1 1/2	3/4	37

HERBACEOUS GROUND COVER: 20LBS./1000 SQUARE FEET.

FOR LAWN AND SEEDING AREAS: 10-6.4 5000 ORGANIC FERTILIZER AT THE RATE OF 20LBS. PER 1,000 SQUARE FEET (OR AS REQUIRED BY TOPSOIL ANALYSIS REPORT)

- ALL PLANT MATERIAL MUST COMPLY WITH THE RECOMMENDATIONS AND REQUIREMENTS OF ANSI Z60.1 'STANDARD FOR NURSERY STOCK'.
- PLANT QUANTITIES ARE GIVEN FOR COMPARISON PURPOSES ONLY. CONTRACTOR IS RESPONSIBLE FOR CONFIRMING PLANT COUNTS AND SHALL BE RESPONSIBLE FOR PROVIDING ALL PLANT MATERIAL SHOWN ON THE DRAWING. ANY DISCREPANCIES BETWEEN PLANT SCHEDULE QUANTITIES AND PLANS SHALL IMMEDIATELY BE BROUGHT TO THE LANDSCAPE ARCHITECT'S ATTENTION PRIOR TO SUBMISSION OF BID. NO SUBSTITUTIONS OF TYPE OF PLANT MATERIAL OR SIZES OF PLANT MATERIAL WILL BE ACCEPTABLE UNLESS APPROVED BY THE LANDSCAPE ARCHITECT AND PLANNING DEPARTMENT. ANY CHANGES TO AN APPROVED LANDSCAPE PLAN MUST BE AUTHORIZED BY THE LANDSCAPE ARCHITECT.
- APPLY ANTI-DESICCANT PRIOR TO THE ONSET OF WINTER AND AGAIN IN MID-WINTER, USING POWER SPRAY TO PROVIDE AN ADEQUATE FILM OVER TRUNKS, BRANCHES, STEMS, TWIGS, AND FOLIAGE. IF DEADWOOD TREES OR SHRUBS ARE MOVED IN LEAF, SPRAY WITH ANTI-DESICCANT AT NURSERY BEFORE MOVING AND AGAIN TWO WEEKS AFTER INSTALLATION.
- ALL PLANTED TREES, SHRUBS, GROUND COVERS AND ANNUAL FLOWERS, SHALL BE MAINTAINED UNTIL FINAL ACCEPTANCE OF THE COMPLETED CONTRACT, OR WHEN INSTALLATION IS ACCEPTED AND MAINTENANCE IS TRANSFERRED TO OWNER. MAINTENANCE SHALL INCLUDE WATERING, CULTIVATING, CONTROL OF INSECTS, FUNGUS, AND OTHER HORTICULTURAL OPERATIONS NECESSARY FOR THE PROPER GROWTH OF ALL PLANT MATERIAL.
- PLANT LOCATIONS SHOWN ON THE PLAN ARE APPROXIMATE AND SUBJECT TO FIELD AND UTILITY LOCATIONS. ALL PROPOSED TREES INSTALLED A MINIMUM OF 10 FEET AWAY FROM ALL UNDERGROUND UTILITIES (AS MEASURED FROM THE TRUNK).
- ALL PARKING LOT ISLANDS TO BE MULCHED WITH HARDWOOD MULCH.
- SEE SHEET LS3 FOR PLANTING DETAILS

DAYDREAM BELIEVER LLC
ALBERT M. DEMERICH RLA, ASLA
LANDSCAPE ARCHITECT
REGISTERED: DELAWARE - NEW JERSEY - NEW YORK
PENNSYLVANIA - VIRGINIA
31056 HARBOR COVE DRIVE - LONG NECK - DE 19966
TEL: (302)945-2495 DIRECT: (201)893-5024
FAX: (302)945-3908 E-MAIL: AMDEM@DNSS.COM

LANDSCAPE LEGEND

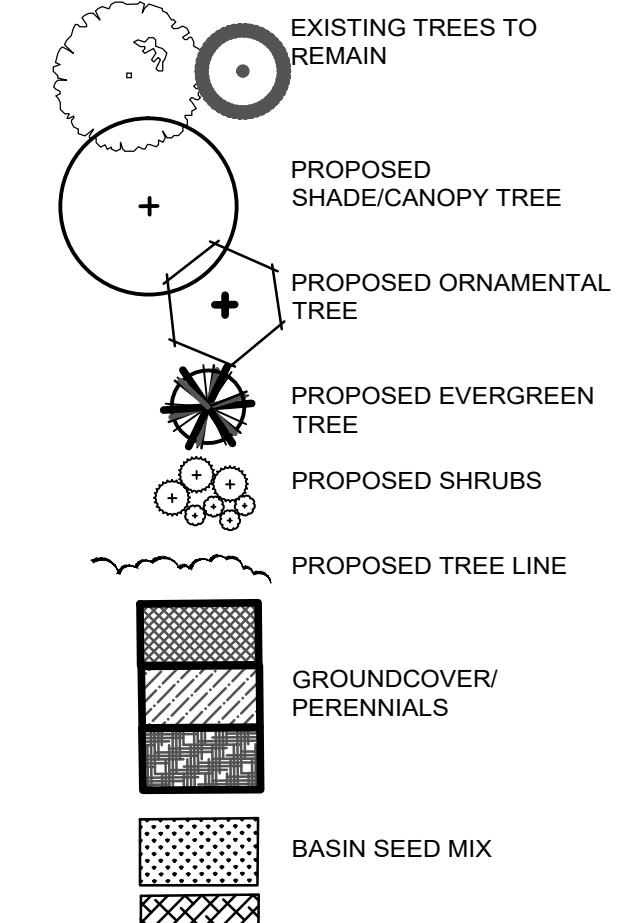

AHD AVENUE
PO BOX 430
HOCKESSIN, DE 19707
AHD@AVENUEPORT.COM
302.889.6014



THIS PLAN HAS BEEN PREPARED SPECIFICALLY FOR THE CLIENT AND PROJECT DESIGNATED HEREON. ANY REUSE OF THIS PLAN OR REVISION, MODIFICATION, OR ALTERATION WITHOUT WRITTEN CONSENT OF AHD AVENUE PORT LLC IS PROHIBITED BY LAW. COPYRIGHT 2023 AHD AVENUE PORT LLC. ALL RIGHTS RESERVED.

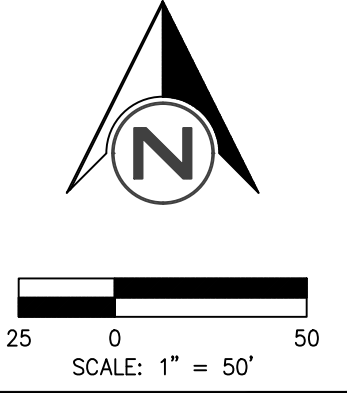

LANDSCAPE DEVELOPMENT
PLANTING PLAN
BRIDGEVILLE TOWN CENTER
TOWN OF BRIDGEVILLE
SUSSEX COUNTY, DELAWARE

NEW LANDSCAPE ARCHITECT	AMD 2-15-24
AGENCY COMMENTS	CMK 5-18-23
REVISIONS	DATE
DATE:	7-15-22
DRAWN BY: AMD	CHECKED: AMD
FILE:	4270BD2.pro
PROJECT NO.:	4270
SHEET NO.:	LS1

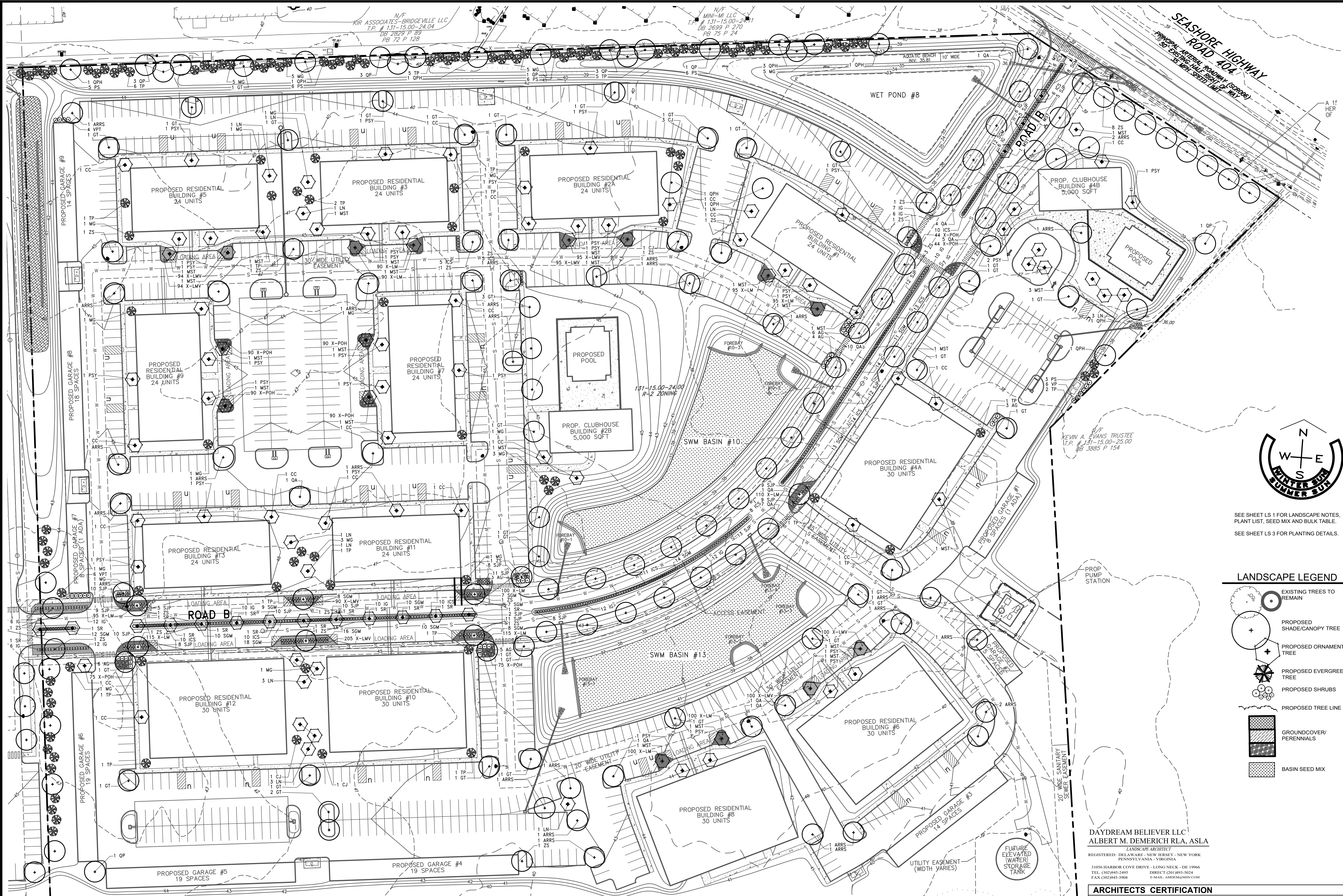

SEE SHEET LS 1 FOR LANDSCAPE NOTES, PLANT LIST, SEED MIX AND BULK TABLE.
SEE SHEET LS 3 FOR PLANTING DETAILS.

LANDSCAPE LEGEND

- EXISTING TREES TO REMAIN
- PROPOSED SHADE/CANOPY TREE
- PROPOSED ORNAMENTAL TREE
- PROPOSED EVERGREEN TREE
- PROPOSED SHRUBS
- PROPOSED TREE LINE
- GROUNDCOVER/PERENNIALS
- BASIN SEED MIX

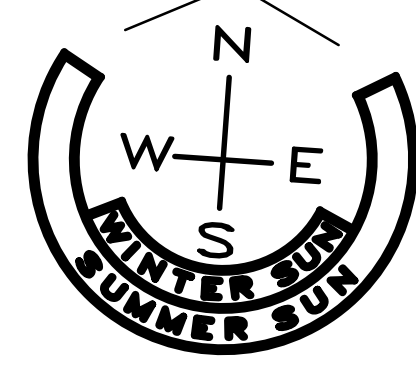

DAYDREAM BELIEVER LLC
ALBERT M. DEMERICH RLA, ASLA
LANDSCAPE ARCHITECT
REGISTERED: DELAWARE - NEW JERSEY - NEW YORK
PENNSYLVANIA - VIRGINIA
3105 HARBOR COVE DRIVE - LONG NECK, DE 19966
TEL: (302)945-2495 DIRECT: (203)893-5024
FAX: (302)945-3908 E-MAIL: ALM@DMBSR.COM

ARCHITECTS CERTIFICATION

I, Albert M. Demerich, RLA, ASLA, HEREBY CERTIFY THAT I AM A REGISTERED LANDSCAPE ARCHITECT IN THE STATE OF DELAWARE, THAT THE LANDSCAPE INFORMATION SHOWN HEREON HAS BEEN PREPARED UNDER MY SUPERVISION AND TO MY BEST KNOWLEDGE AND BELIEF, REPRESENTS GOOD LANDSCAPE PRACTICES.

ALBERT M. DEMERICH, RLA, ASLA LICENSE #: S1-0000394
FEBRUARY 12, 2024
DATE

AH DAVENPORT
PO BOX 430
HOCKESSIN, DE 19707
AHD@DAVENPORT.COM
302.889.6014



THIS PLAN HAS BEEN PREPARED SPECIALLY FOR THE CLIENT AND PROJECT DESIGNATED HEREON. ANY REUSE OR REPRODUCTION, DUPLICATION OR USE, WITHOUT WRITTEN CONSENT OF A.H. DAVENPORT LLC IS PROHIBITED BY LAW. COPYRIGHT 2023 A.H. DAVENPORT LLC. ALL RIGHTS RESERVED.

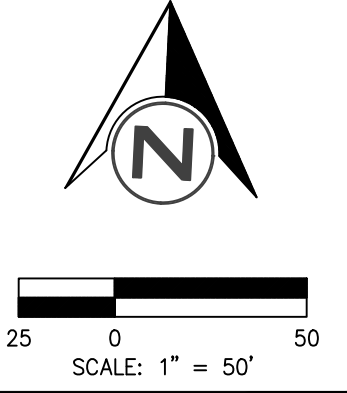

LANDSCAPE DEVELOPMENT
PLANTING PLAN
BRIDGEVILLE TOWN CENTER
TOWN OF BRIDGEVILLE
SUSSEX COUNTY, DELAWARE

NEW LANDSCAPE ARCHITECT	AMD 2-15-24
AGENCY COMMENTS	CMK 5-18-23
REVISIONS	DATE
DATE:	7-15-22
DRAWN BY: AMD	CHECKED: AMD
FILE:	4270BD2.pro
PROJECT NO.:	4270
SHEET NO.	LS2

PLANTING NOTES:

1. CROWN OF ROOT BALL SHALL BEAR SAME RELATION (OR SLIGHTLY ABOVE) TO FINISHED GRADE AS IT BORE TO PREVIOUS GRADE.
2. DO NOT DAMAGE MAIN ROOTS OR DESTROY ROOT BALL WHEN INSTALLING TREE SUPPORT POSTS.
3. REMOVE HOSE AND POST AT END OF GUARANTEE PERIOD (OR NO LONGER THAN 12 MONTHS).
4. CONTRACTOR TO PROVIDE PROTECTION AGAINST DEER RUB/RUT WHICH IS NOT DIRECTLY ATTACHED TO TRUNK. (AS APPROVED)

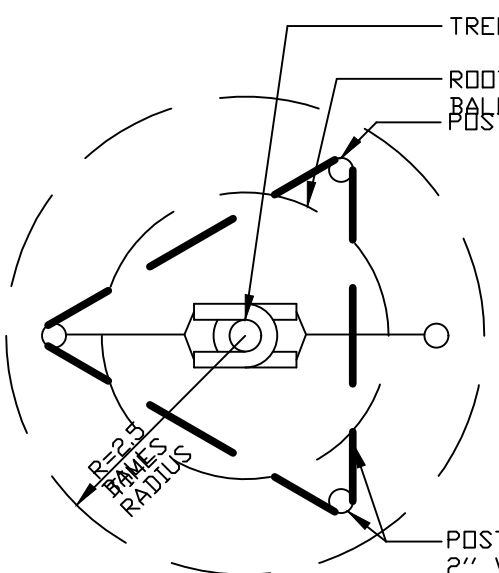

PLAN

1" X 2" WOOD BRACE NAILED TO POSTS FOR TREES OVER 3" CAL.

- POSTS TO BE WHITE CEDAR AS FOLLOWS:
- (1) 2- 2 1/2" DIA. POST (MINOR TREE) 4' POST HEIGHT
 - (2) 3- 3 1/2" DIA. POSTS (MAJOR TREES TO 3" CAL.) 5' POST HEIGHT
 - (3) 3- 3 1/2" DIA. POSTS (MAJOR TREES OVER 3" CAL.) 7' POST HEIGHT
- POST SHALL EXTEND BELOW FINISHED GRADE 2'-6" MIN.
- CUT ROPES AT TOP OF BALL REMOVE TOP 1/3 OF BURLAP

GCS TREESTRAP #2024, AVAILABLE FROM GCS, INC., 230 CENTER STREET, NORTH WALES, PA 19454. (215) 661-9070

NO. 10 GAUGE GALVANIZED ANNEALED STEEL WIRE TWISTED 2 STRANDS DOUBLE WRAPPED

VARIABLES (SHALL BE 6" BEYOND BALL MINIMUM.)

3" DEPTH (AFTER SETTLEMENT) OF SHREDDED HARDWOOD MULCH. NO MULCH SHOULD BE TOUCHING TREE TRUNKS

Lawn Or Fin. Grade

MULCH RADIUS

3'-0" (MAX)

SPECIFIED PLANTING BACKFILL MIX

UNDISTURBED SOIL UNDER BALL

RADIUS= 2.5 TIMES BALL RADIUS

SECTION

DETAIL: TREE PLANTING

SCALE: NOT TO SCALE

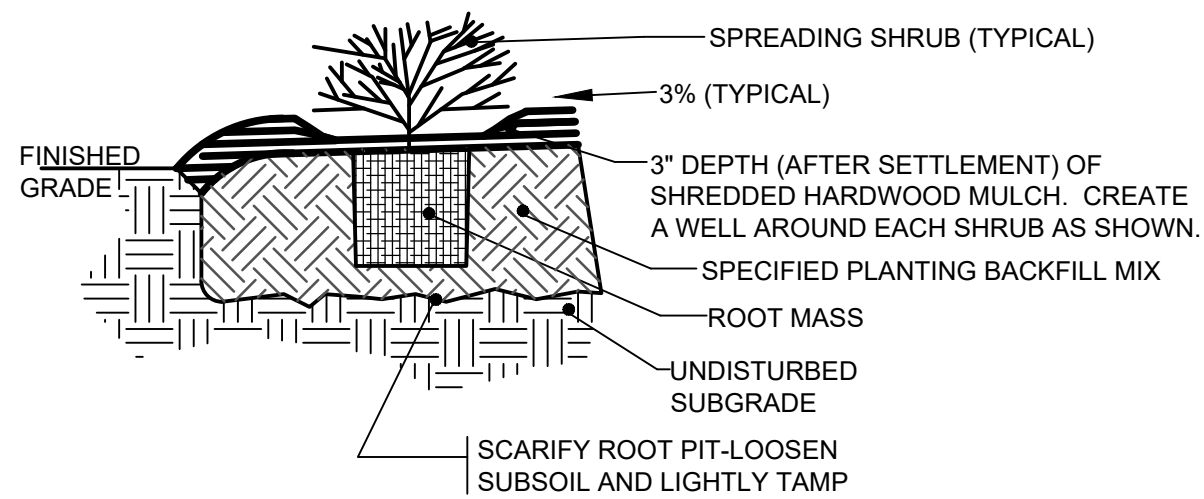

1. CROWN OF ROOT MASS TO BE SLIGHTLY ABOVE EXISTING GRADE. IF DRAINAGE IS QUESTIONABLE NOTIFY LANDSCAPE ARCHITECT IMMEDIATELY FOR DECISION.
2. FOR BARE ROOT SHRUBS: THIN BRANCHES AND FOLIAGE (NOT ALL END TIPS) BY 1/3 RETAINING NORMAL PLANT SHAPE. (BARE ROOT PLANTS ONLY).
3. FOR CONTAINER SHRUBS: REMOVE POT, CHECK ROOT SYSTEM. IF THERE ARE ANY SIGNS OF BEING ROOT BOUND, SLASH ROOT MASS (WITH A SHARP KNIFE) VERTICALLY IN 4 EQUIDISTANT LOCATIONS.
4. FOR BALLED AND BURLAPPED SHRUBS: REMOVE COLLAR ROPES AND TOP 1/3 OF BURLAP. 5. CROWN OR SLOPE ALL SHRUB BEDS TO ASSURE A MIN. PITCH OF 3%.

DETAIL: SHRUB PLANTING

SCALE: NOT TO SCALE

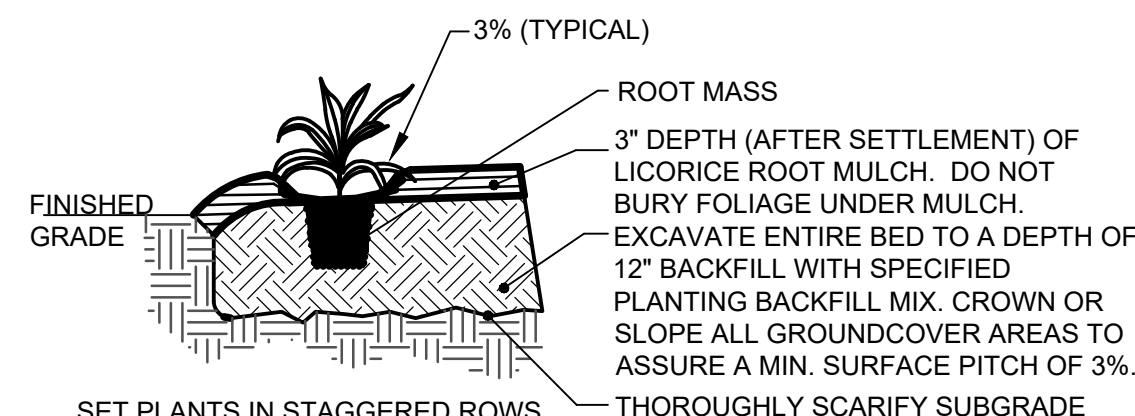

SET PLANTS IN STAGGERED ROWS AT SPECIFIED SPACING. MULCH ENTIRE BED WITH LICORICE ROOT MULCH. (OR APPROVED EQUAL) (GROUNDCOVER, FLOWERS, AND PERENNIAL BEDS ONLY).

DETAIL: PERENNIAL PLANTING

SCALE: NOT TO SCALE

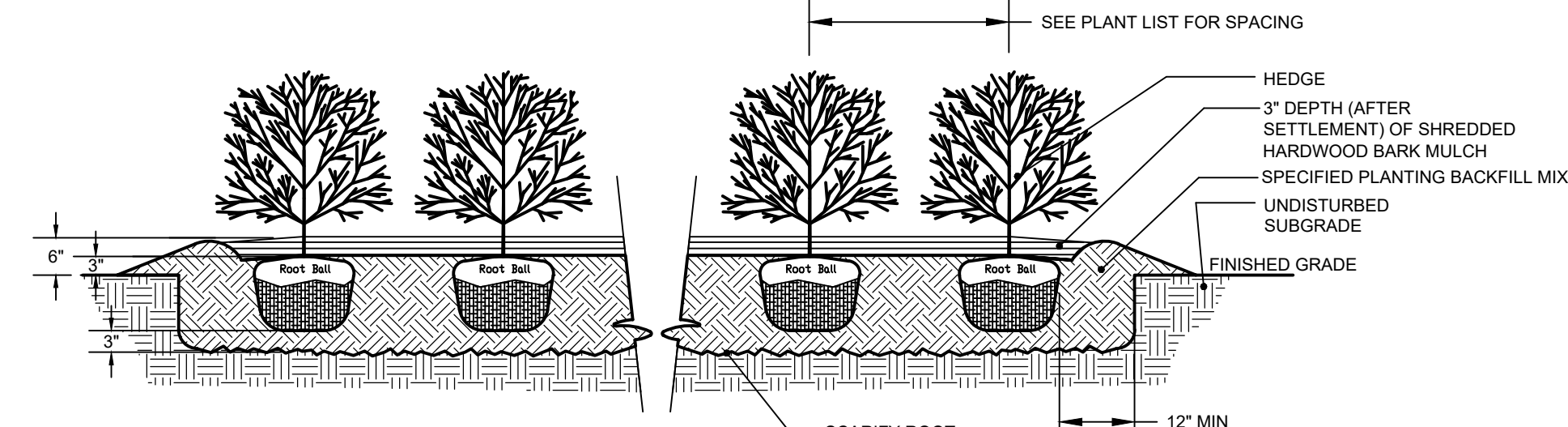

- NOTE:
1. CROWN OF ROOT BALL TO BE APPROXIMATELY 3" ABOVE EXISTING GRADE.
 2. REMOVE COLLAR ROPES AND BURLAP FROM TOP 1/3 OF ROOT BALL.
 3. HEDGE PLANTING TRENCH SHALL BE CONTINUOUS FOR ENTIRE LENGTH OF HEDGE.

DETAIL: HEDGE PLANTING

SCALE: NOT TO SCALE

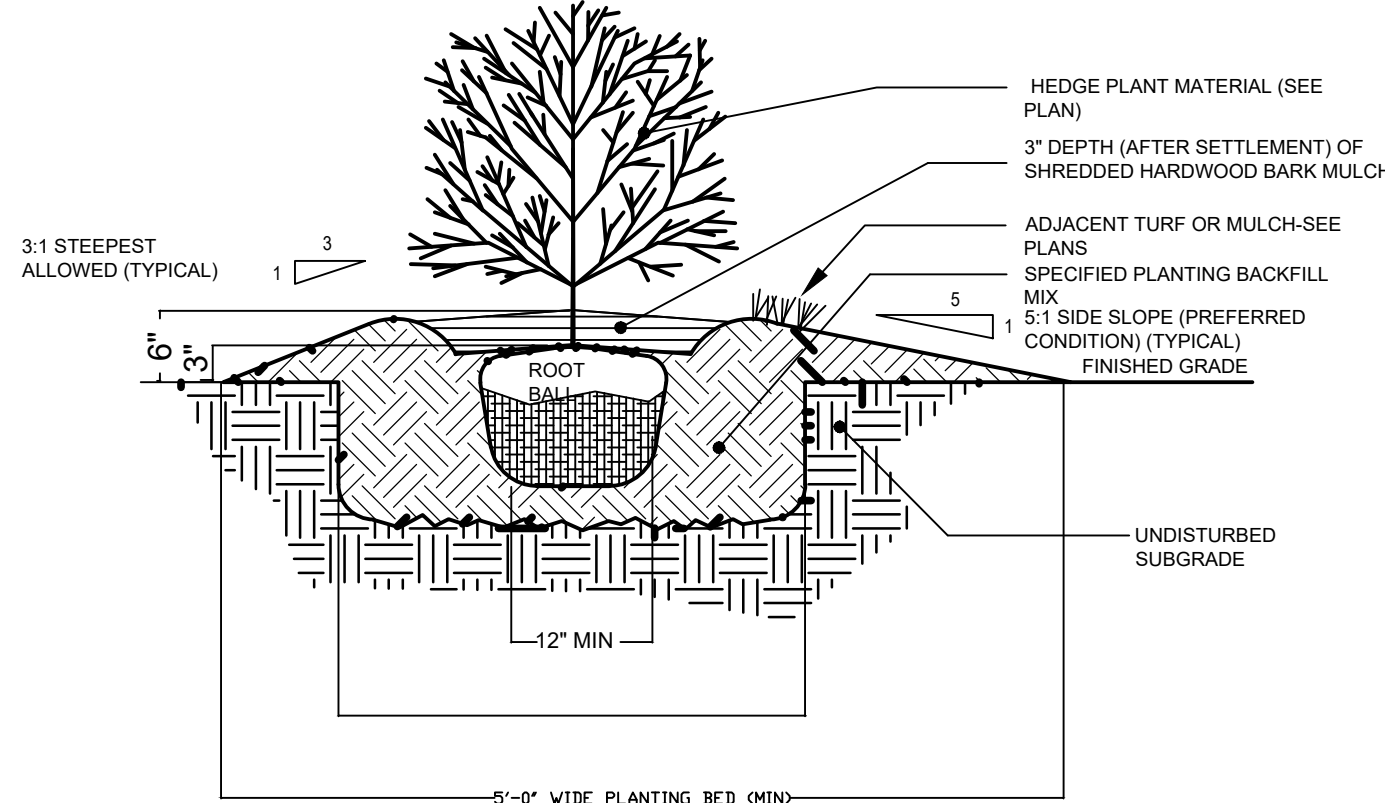

DETAIL: HEDGE PLANTING CROSS SECTION

SCALE: NOT TO SCALE

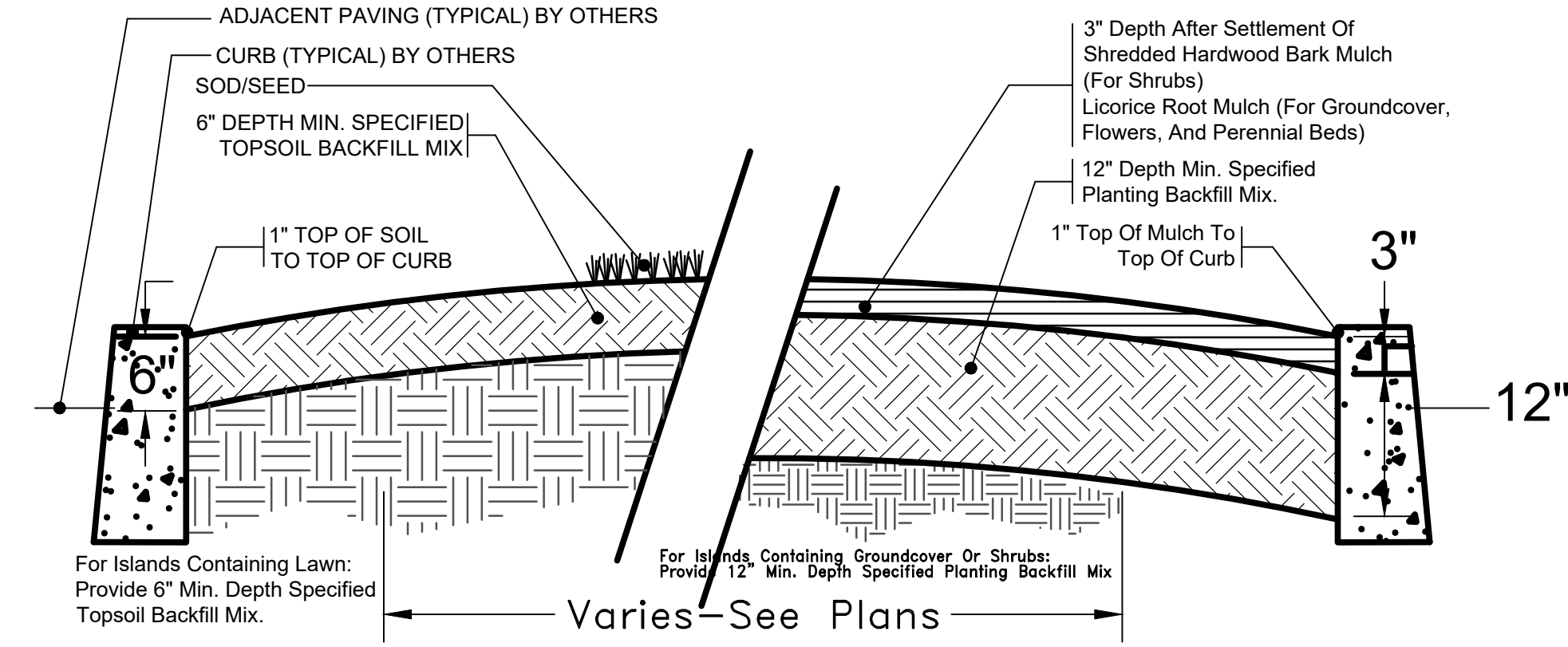

DETAIL: ISLAND

SCALE: NOT TO SCALE

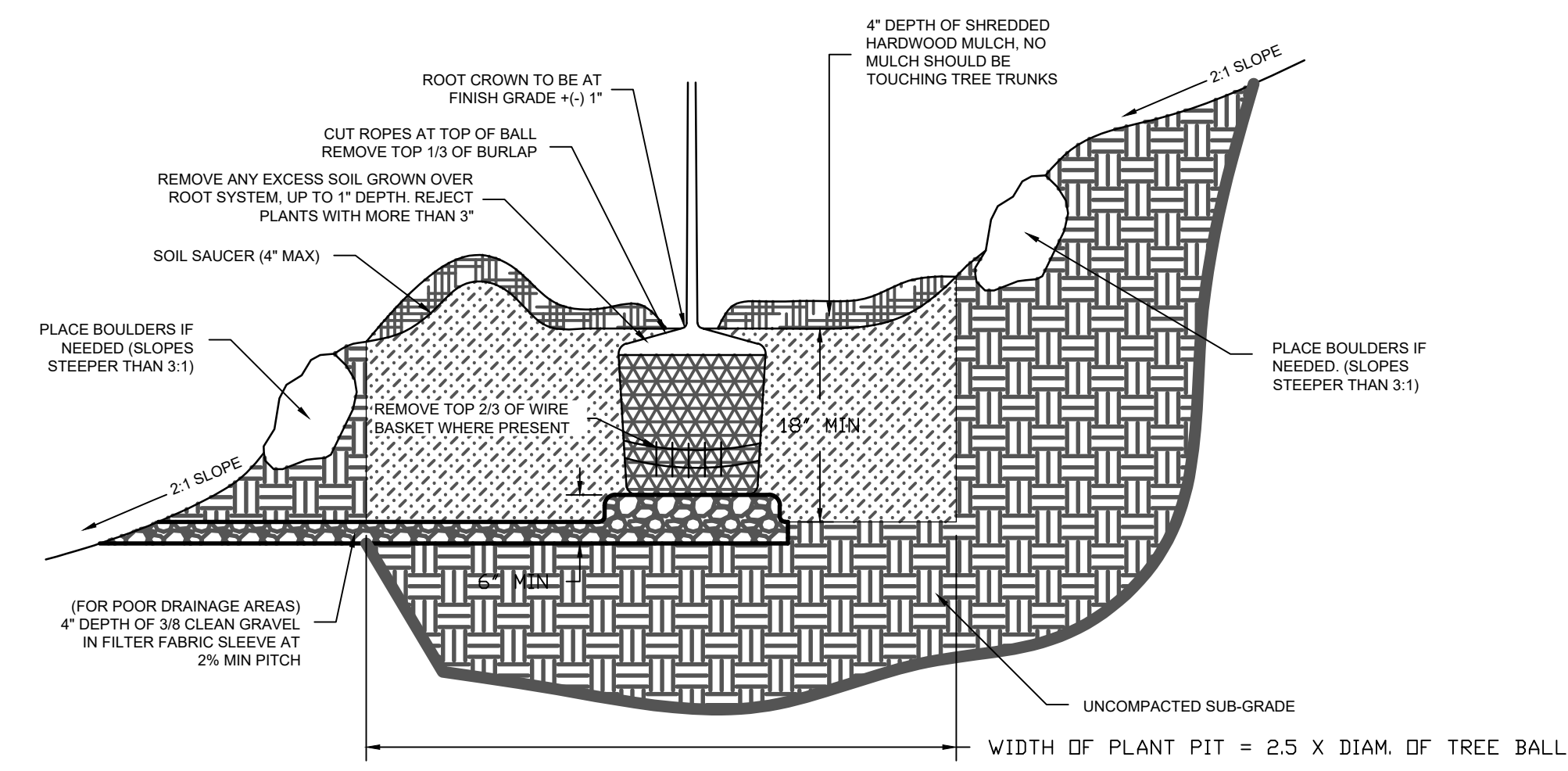

TREE IN SLOPE PLANTING DETAIL

DETAIL: TREE IN SLOPE

SCALE: NOT TO SCALE

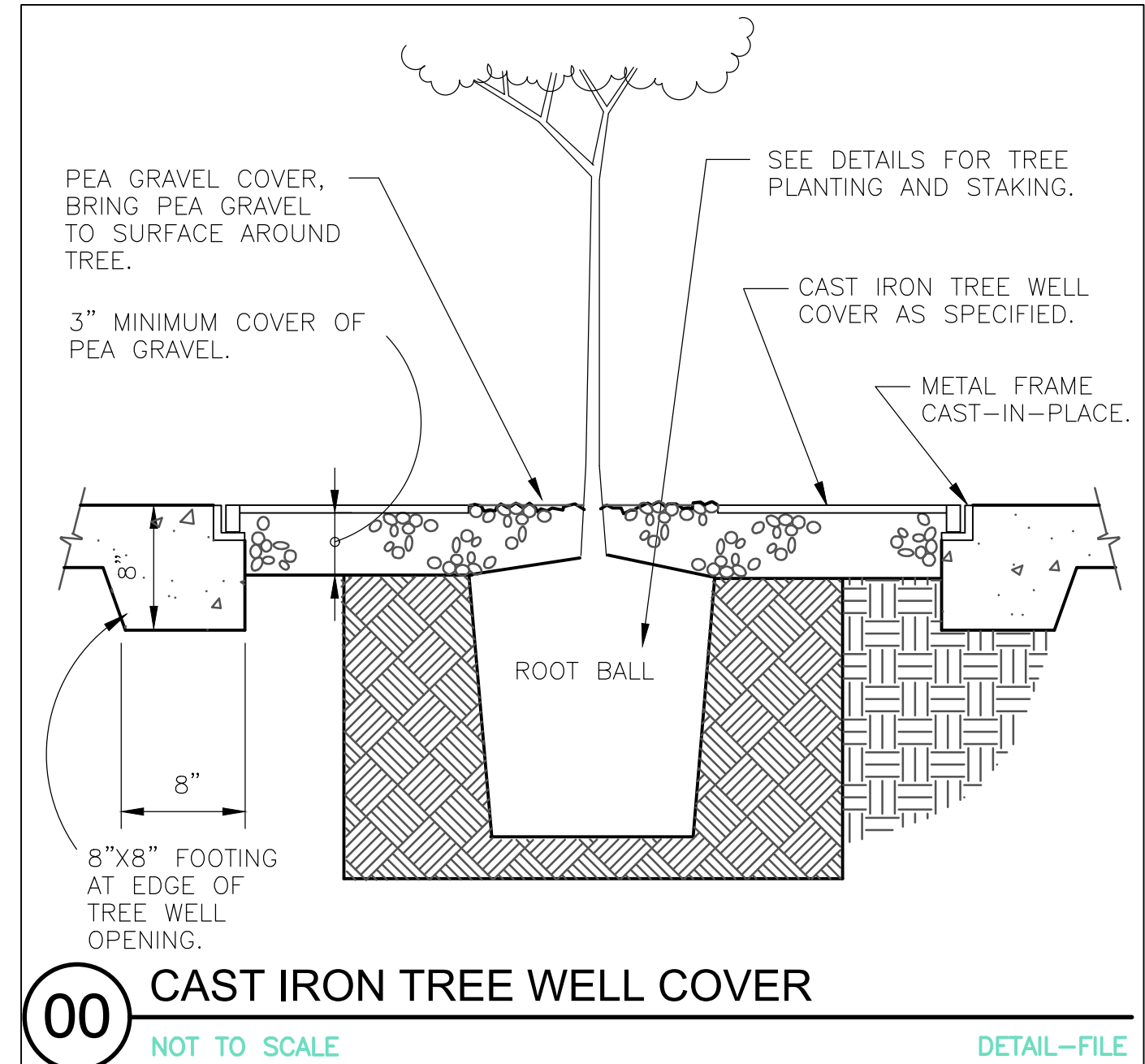

00 CAST IRON TREE WELL COVER

NOT TO SCALE

DETAIL-FILE

DAYDREAM BELIEVER LLC
ALBERT M. DEMERICH RLA, ASLA

REGISTERED DELAWARE - NEW JERSEY - NEW YORK
PENNSYLVANIA - VIRGINIA

31056 HARBOR COVE DRIVE - LONG NECK - DE 19966
TEL: (302)945-2495 DIRECT: (201)893-5024
FAX: (302)945-3908 E-MAIL: ANDRE@DMR.COM

ARCHITECTS CERTIFICATION

I, Albert M. Demerich, RLA, ASLA, HEREBY CERTIFY THAT I AM A REGISTERED LANDSCAPE ARCHITECT IN THE STATE OF DELAWARE, THAT THE LANDSCAPE INFORMATION SHOWN HEREON HAS BEEN PREPARED UNDER MY SUPERVISION AND TO MY BEST KNOWLEDGE AND BELIEF, REPRESENTS GOOD LANDSCAPE PRACTICES.

Albert M. Demerich, RLA, ASLA LICENSE #: S1-0000394
DATE: FEBRUARY 12, 2024

AH DAYVENPORT
PO BOX 430
HOCKESSIN, DE 19707
AHDAYVENPORT.COM
302.889.6014



THIS PLAN HAS BEEN PREPARED SPECIFICALLY FOR THE CLIENT AND PROJECT DESIGNATED HEREON. ANY REPRODUCTION, REVISION, DUPLICATION OR USE WITHOUT WRITTEN CONSENT OF A.H. DAYVENPORT LLC IS PROHIBITED BY LAW. COPYRIGHT 2023 A.H. DAYVENPORT LLC. ALL RIGHTS RESERVED.

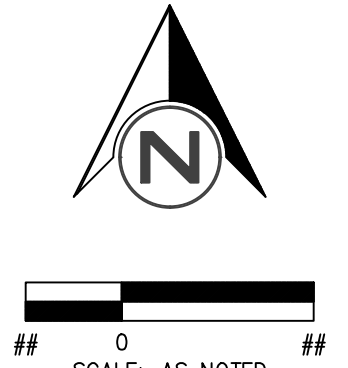

LANDSCAPE DEVELOPMENT
PLANTING PLAN
BRIDGEVILLE TOWN CENTER
TOWN OF BRIDGEVILLE
SUSSEX COUNTY, DELAWARE

NEW LANDSCAPE ARCHITECT	AMD 2-15-24
AGENCY COMMENTS	CMK 5-18-23
REVISIONS	DATE
DATE:	7-15-22
DRAWN BY: AMD	CHECKED: AMD
FILE:	4270BD2.pro
PROJECT NO.:	4270

SHEET NO.
LS3

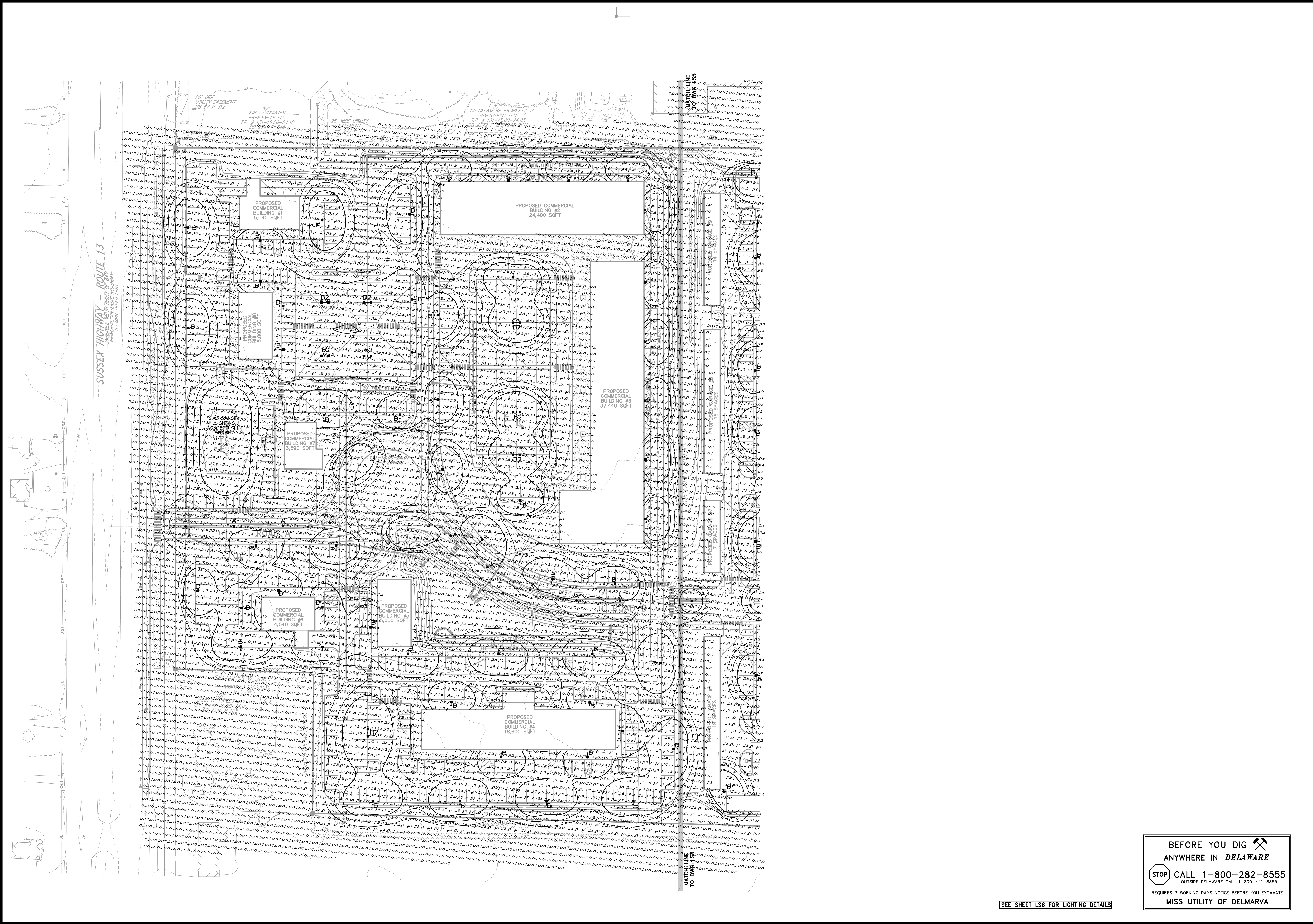

SUSSEX HIGHWAY - ROUTE 13
 55 MPH SPEED LIMIT

PROPOSED COMMERCIAL BUILDING #1
 5,040 SFT

PROPOSED COMMERCIAL BUILDING #2
 24,400 SFT

PROPOSED COMMERCIAL BUILDING #3
 37,440 SFT

PROPOSED COMMERCIAL BUILDING #5
 4,540 SFT

PROPOSED COMMERCIAL BUILDING #4
 16,000 SFT



AH
HOZEN
ADAV
PORT
COM
 AHDAVENPORT.COM
 302.889.6014
 HOCKESSIN, DE 19707

SEAL

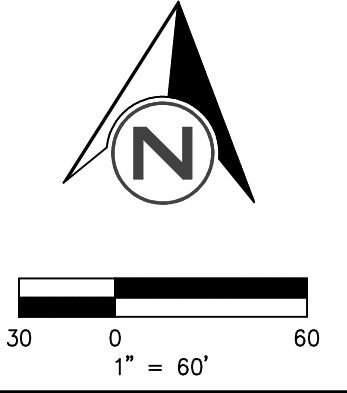
THIS PLAN HAS BEEN PREPARED SPECIFICALLY FOR THE CLIENT AND PROJECT DESIGNATED HEREON. ANY REPRODUCTION OR UNAUTHORIZED DUPLICATION OR USE WITHOUT WRITTEN CONSENT OF A.H. DAVENPORT LLC IS PROHIBITED BY LAW. COPYRIGHT 2023 A.H. DAVENPORT LLC. ALL RIGHTS RESERVED.



LIGHTING PLAN
 BRIDGEVILLE TOWN CENTER
 TOWN OF BRIDGEVILLE
 SUSSEX COUNTY, DELAWARE

BEFORE YOU DIG 
ANYWHERE IN DELAWARE
 CALL 1-800-282-8555
 OUTSIDE DELAWARE CALL 1-800-441-8355
 REQUIRES 3 WORKING DAYS NOTICE BEFORE YOU EXCAVATE
 MISS UTILITY OF DELMARVA

SEE SHEET LS6 FOR LIGHTING DETAILS

AGENCY COMMENTS	CHK	5-18-23
REVISIONS	DATE	
DATE:	7-15-22	
DRAWN BY: CMK	CHECKED: AJH	
FILE:	4270BD2.pro	
PROJECT NO.:	4270	
SHEET NO.	LS4	

A Radean Post Top LED Area Luminaire



Specifications:
 EPA: 1.02 ft² (0.103 m²)
 Length: 24" (61cm)
 Width: 24" (61cm)
 H1 Luminaire Height: 4" (10.16cm)
 H2 Luminaire Height: 26" (66.04cm)
 Weight: 38 lbs (17.24kg)

Ordering Information
 EXAMPLE: RADPT LED P3 30K SYM MVOLT PT4 PIR DNAXD

Series	Pre-mount package	Color temperature	Beam spread	Mounting	
RADPT LED	P1 2000 Lumens P2 3000 Lumens P3 5000 Lumens P4 10000 Lumens P5 15000 Lumens	27K 2700K 30K 3000K 35K 3500K 40K 4000K 50K 5000K	SYM Symmetric type IV ASY Asymmetric type IV PRM Flatbar type III	MVOLT 277 120 240 300	SR Square mounting (includes adapter) RPA Round pipe mounting WB Wall bracket

Introduction
 The architecturally-inspired shape of the RADEAN™ post top area luminaire embodies the grace and strength of the RADBAN family. The twin copper-rope cast aluminum arms support the slender superstructure, creating a beautiful sculpture by day transforming into a beacon of comfort by night. Triangular arms redirect reflection maintaining its visually quiet appearance. With sleek lines and simple silhouettes, these LED luminaires use specialized lighting and visual comfort to transform common areas like courtyards, outdoor retail locations, universities and corporate campuses into pedestrian-friendly nighttime environments.

B Radean Arm Mount LED Area Luminaire



Specifications:
 EPA: 0.75 ft² (0.05 m²)
 Length: L1 24" (61cm)
 L2 30" (60.96 cm)
 Width: 24" (61cm)
 Height: 4" (10.2cm)
 Weight (max): 29 lbs (13.15kg)

Ordering Information
 EXAMPLE: RAD1 LED P3 30K SYM MVOLT RPA PE DNAXD

Series	Pre-mount package	Color temperature	Beam spread	Voltage	Mounting
RAD1 LED	P1 3,000 Lumens P2 5,000 Lumens P3 7,000 Lumens P4 11,000 Lumens P5 14,000 Lumens	27K 2700K 30K 3000K 35K 3500K 40K 4000K 50K 5000K	SYM Symmetric type IV ASY Asymmetric type IV PRM Flatbar type III	MVOLT 277 120 240 300	SR Square mounting (includes adapter) RPA Round pipe mounting WB Wall bracket

Introduction
 The RADEAN arm mount luminaire is the perfect choice for pedestrian applications where daytime aesthetics and visual comfort are needed. Adding architectural flair to any space, the RADEAN's low-profile shape and smooth curves blend in while adding a touch of elegance. Perfect for campuses, parks, pedestrian malls, courtyards and pathways, the RADEAN arm mount is the Architect's choice to provide beautiful aesthetics both day and night.

C Contractor Select™ TWH/TWP LED Wall Pack



Specifications:
 EPA: 1.02 ft² (0.103 m²)
 Length: 16 1/4" (41.3 cm)
 Width: 15 3/4" (40.0 cm)
 Depth: 9" (22.9 cm)
 Weight: 28 lbs (12.7 kg)

Ordering Information
 EXAMPLE: TWH LED 400W 4000K 4000K 70 CRU 120V 120V 120V 120V

Series	Pre-mount package	Color temperature	Beam spread	Voltage	Mounting
TWH LED	400W 4000K 400W 5000K 400W 6000K 400W 7000K 400W 8000K 400W 9000K 400W 10000K 400W 11000K 400W 12000K 400W 13000K 400W 14000K 400W 15000K	4000K 5000K 6000K 7000K 8000K 9000K 10000K 11000K 12000K 13000K 14000K 15000K	4000K 5000K 6000K 7000K 8000K 9000K 10000K 11000K 12000K 13000K 14000K 15000K	120V 120V 120V 120V 120V 120V 120V 120V 120V 120V 120V 120V	120V 120V 120V 120V 120V 120V 120V 120V 120V 120V 120V 120V

Introduction
 Cast in a traditional dayform, the TWH LED wall pack luminaires come standard with adjustable light output allowing the distributor to reduce inventory, adjust to customer's needs and save energy compared to traditional light sources. The TWH LED luminaire provide two choices in wall pack construction. The TWH's glass refractor provides a long life solution with great optical control.

Ordering Information
 EXAMPLE: RADPT LED P3 30K SYM MVOLT PT4 PIR DNAXD

Series	Pre-mount package	Color temperature	Beam spread	Mounting	
RADPT LED	P1 2000 Lumens P2 3000 Lumens P3 5000 Lumens P4 10000 Lumens P5 15000 Lumens	27K 2700K 30K 3000K 35K 3500K 40K 4000K 50K 5000K	SYM Symmetric type IV ASY Asymmetric type IV PRM Flatbar type III	MVOLT 277 120 240 300	SR Square mounting (includes adapter) RPA Round pipe mounting WB Wall bracket

Control Options

Control Option	Other options	Shipped separately
SHIPPED INSTALLED	SE Single Face ¹ DF Double Face ² L90 Left angled optics R90 Right angled optics	SHIPPED SEPARATELY HS Housing shield ³

Accessories

Accessories	Other options
SHIPPED INSTALLED	SHIPPED SEPARATELY
SHIPPED SEPARATELY	SHIPPED SEPARATELY

Ordering Information
 EXAMPLE: RAD1 LED P3 30K SYM MVOLT RPA PE DNAXD

Series	Pre-mount package	Color temperature	Beam spread	Voltage	Mounting
RAD1 LED	P1 3,000 Lumens P2 5,000 Lumens P3 7,000 Lumens P4 11,000 Lumens P5 14,000 Lumens	27K 2700K 30K 3000K 35K 3500K 40K 4000K 50K 5000K	SYM Symmetric type IV ASY Asymmetric type IV PRM Flatbar type III	MVOLT 277 120 240 300	SR Square mounting (includes adapter) RPA Round pipe mounting WB Wall bracket

Control Options

Control Option	Other options	Shipped separately
SHIPPED INSTALLED	SE Single Face ¹ DF Double Face ² L90 Left angled optics R90 Right angled optics	SHIPPED SEPARATELY HS Housing shield ³

Accessories

Accessories	Other options
SHIPPED INSTALLED	SHIPPED SEPARATELY
SHIPPED SEPARATELY	SHIPPED SEPARATELY

Contractor Select™ TWH/TWP LED Wall Pack

Cast in a traditional dayform, the TWH LED wall pack luminaires come standard with adjustable light output allowing the distributor to reduce inventory, adjust to customer's needs and save energy compared to traditional light sources. The TWH LED luminaire provide two choices in wall pack construction. The TWH's glass refractor provides a long life solution with great optical control.

FEATURES:

- Replaces up to 400W MH for TWH and 250W for TWP; saves 83% energy
- Traditional form factor, and payback within two years
- Available with glass for TWH or polycarbonate lens for TWP

Ordering Information
 EXAMPLE: TWH LED 400W 4000K 4000K 70 CRU 120V 120V 120V 120V

Series	Pre-mount package	Color temperature	Beam spread	Voltage	Mounting
TWH LED	400W 4000K 400W 5000K 400W 6000K 400W 7000K 400W 8000K 400W 9000K 400W 10000K 400W 11000K 400W 12000K 400W 13000K 400W 14000K 400W 15000K	4000K 5000K 6000K 7000K 8000K 9000K 10000K 11000K 12000K 13000K 14000K 15000K	4000K 5000K 6000K 7000K 8000K 9000K 10000K 11000K 12000K 13000K 14000K 15000K	120V 120V 120V 120V 120V 120V 120V 120V 120V 120V 120V 120V	120V 120V 120V 120V 120V 120V 120V 120V 120V 120V 120V 120V

Control Options

Control Option	Other options	Shipped separately
SHIPPED INSTALLED	SE Single Face ¹ DF Double Face ² L90 Left angled optics R90 Right angled optics	SHIPPED SEPARATELY HS Housing shield ³

Accessories

Accessories	Other options
SHIPPED INSTALLED	SHIPPED SEPARATELY
SHIPPED SEPARATELY	SHIPPED SEPARATELY

Ordering Information
 EXAMPLE: RADPT LED P3 30K SYM MVOLT PT4 PIR DNAXD

Series	Pre-mount package	Color temperature	Beam spread	Voltage	Mounting
RADPT LED	P1 2000 Lumens P2 3000 Lumens P3 5000 Lumens P4 10000 Lumens P5 15000 Lumens	27K 2700K 30K 3000K 35K 3500K 40K 4000K 50K 5000K	SYM Symmetric type IV ASY Asymmetric type IV PRM Flatbar type III	MVOLT 277 120 240 300	SR Square mounting (includes adapter) RPA Round pipe mounting WB Wall bracket

Control Options

Control Option	Other options	Shipped separately
SHIPPED INSTALLED	SE Single Face ¹ DF Double Face ² L90 Left angled optics R90 Right angled optics	SHIPPED SEPARATELY HS Housing shield ³

Accessories

Accessories	Other options
SHIPPED INSTALLED	SHIPPED SEPARATELY
SHIPPED SEPARATELY	SHIPPED SEPARATELY

Ordering Information
 EXAMPLE: RAD1 LED P3 30K SYM MVOLT RPA PE DNAXD

Series	Pre-mount package	Color temperature	Beam spread	Voltage	Mounting
RAD1 LED	P1 3,000 Lumens P2 5,000 Lumens P3 7,000 Lumens P4 11,000 Lumens P5 14,000 Lumens	27K 2700K 30K 3000K 35K 3500K 40K 4000K 50K 5000K	SYM Symmetric type IV ASY Asymmetric type IV PRM Flatbar type III	MVOLT 277 120 240 300	SR Square mounting (includes adapter) RPA Round pipe mounting WB Wall bracket

Control Options

Control Option	Other options	Shipped separately
SHIPPED INSTALLED	SE Single Face ¹ DF Double Face ² L90 Left angled optics R90 Right angled optics	SHIPPED SEPARATELY HS Housing shield ³

Accessories

Accessories	Other options
SHIPPED INSTALLED	SHIPPED SEPARATELY
SHIPPED SEPARATELY	SHIPPED SEPARATELY

Contractor Select™ TWH/TWP LED Wall Pack

Cast in a traditional dayform, the TWH LED wall pack luminaires come standard with adjustable light output allowing the distributor to reduce inventory, adjust to customer's needs and save energy compared to traditional light sources. The TWH LED luminaire provide two choices in wall pack construction. The TWH's glass refractor provides a long life solution with great optical control.

FEATURES:

- Replaces up to 400W MH for TWH and 250W for TWP; saves 83% energy
- Traditional form factor, and payback within two years
- Available with glass for TWH or polycarbonate lens for TWP

Ordering Information
 EXAMPLE: TWH LED 400W 4000K 4000K 70 CRU 120V 120V 120V 120V

Series	Pre-mount package	Color temperature	Beam spread	Voltage	Mounting
TWH LED	400W 4000K 400W 5000K 400W 6000K 400W 7000K 400W 8000K 400W 9000K 400W 10000K 400W 11000K 400W 12000K 400W 13000K 400W 14000K 400W 15000K	4000K 5000K 6000K 7000K 8000K 9000K 10000K 11000K 12000K 13000K 14000K 15000K	4000K 5000K 6000K 7000K 8000K 9000K 10000K 11000K 12000K 13000K 14000K 15000K	120V 120V 120V 120V 120V 120V 120V 120V 120V 120V 120V 120V	120V 120V 120V 120V 120V 120V 120V 120V 120V 120V 120V 120V

Control Options

Control Option	Other options	Shipped separately
SHIPPED INSTALLED	SE Single Face ¹ DF Double Face ² L90 Left angled optics R90 Right angled optics	SHIPPED SEPARATELY HS Housing shield ³

Accessories

Accessories	Other options
SHIPPED INSTALLED	SHIPPED SEPARATELY
SHIPPED SEPARATELY	SHIPPED SEPARATELY

Ordering Information
 EXAMPLE: RADPT LED P3 30K SYM MVOLT PT4 PIR DNAXD

Series	Pre-mount package	Color temperature	Beam spread	Voltage	Mounting
RADPT LED	P1 2000 Lumens P2 3000 Lumens P3 5000 Lumens P4 10000 Lumens P5 15000 Lumens	27K 2700K 30K 3000K 35K 3500K 40K 4000K 50K 5000K	SYM Symmetric type IV ASY Asymmetric type IV PRM Flatbar type III	MVOLT 277 120 240 300	SR Square mounting (includes adapter) RPA Round pipe mounting WB Wall bracket

Control Options

Control Option	Other options	Shipped separately
SHIPPED INSTALLED	SE Single Face ¹ DF Double Face ² L90 Left angled optics R90 Right angled optics	SHIPPED SEPARATELY HS Housing shield ³

Accessories

Accessories	Other options
SHIPPED INSTALLED	SHIPPED SEPARATELY
SHIPPED SEPARATELY	SHIPPED SEPARATELY

Ordering Information
 EXAMPLE: RAD1 LED P3 30K SYM MVOLT RPA PE DNAXD

Series	Pre-mount package	Color temperature	Beam spread	Voltage	Mounting
RAD1 LED	P1 3,000 Lumens P2 5,000 Lumens P3 7,000 Lumens P4 11,000 Lumens P5 14,000 Lumens	27K 2700K 30K 3000K 35K 3500K 40K 4000K 50K 5000K	SYM Symmetric type IV ASY Asymmetric type IV PRM Flatbar type III	MVOLT 277 120 240 300	SR Square mounting (includes adapter) RPA Round pipe mounting WB Wall bracket

Control Options

Control Option	Other options	Shipped separately
SHIPPED INSTALLED	SE Single Face ¹ DF Double Face ² L90 Left angled optics R90 Right angled optics	SHIPPED SEPARATELY HS Housing shield ³

Accessories

Accessories	Other options
SHIPPED INSTALLED	SHIPPED SEPARATELY
SHIPPED SEPARATELY	SHIPPED SEPARATELY

Contractor Select™ TWH/TWP LED Wall Pack

Cast in a traditional dayform, the TWH LED wall pack luminaires come standard with adjustable light output allowing the distributor to reduce inventory, adjust to customer's needs and save energy compared to traditional light sources. The TWH LED luminaire provide two choices in wall pack construction. The TWH's glass refractor provides a long life solution with great optical control.

FEATURES:

- Replaces up to 400W MH for TWH and 250W for TWP; saves 83% energy
- Traditional form factor, and payback within two years
- Available with glass for TWH or polycarbonate lens for TWP

Ordering Information
 EXAMPLE: TWH LED 400W 4000K 4000K 70 CRU 120V 120V 120V 120V

Series	Pre-mount package	Color temperature	Beam spread	Voltage	Mounting
TWH LED	400W 4000K 400W 5000K 400W 6000K 400W 7000K 400W 8000K 400W 9000K 400W 10000K 400W 11000K 400W 12000K 400W 13000K 400W 14000K 400W 15000K	4000K 5000K 6000K 7000K 8000K 9000K 10000K 11000K 12000K 13000K 14000K 15000K	4000K 5000K 6000K 7000K 8000K 9000K 10000K 11000K 12000K 13000K 14000K 15000K	120V 120V 120V 120V 120V 120V 120V 120V 120V 120V 120V 120V	120V 120V 120V 120V 120V 120V 120V 120V 120V 120V 120V 120V

Control Options

Control Option	Other options	Shipped separately
SHIPPED INSTALLED	SE Single Face ¹ DF Double Face ² L90 Left angled optics R90 Right angled optics	SHIPPED SEPARATELY HS Housing shield ³

Accessories

Accessories	Other options
SHIPPED INSTALLED	SHIPPED SEPARATELY
SHIPPED SEPARATELY	SHIPPED SEPARATELY

AH DAVENPORT
 HOCKESSIN, DE 19707
 PO BOX 430
 HOCKESSIN, DE 19707
 AHDAVENPORT.COM
 302.889.6014

BRIDGEVILLE TOWN CENTER
 TOWN OF BRIDGEVILLE
 SUSSEX COUNTY, DELAWARE

LIGHTING DETAILS

AGENCY COMMENTS: CMR 5-18-23
 REVISIONS: DATE: 7-15-22
 DATE: 7-15-22
 DRAWN BY: CMK CHECKED: ALH
 FILE: 4270BD2.pro
 PROJECT NO.: 4270
 SHEET NO. LS6